

**EMARIT
INSTALLATION
DETAILS**

CONTENTS

INTRODUCTION	1
STROGE	1
HEAT AND HUMIDITY INSULATION	1
HANDLING	1
IMPORTANT ISSUES WHILE ASSEMBLING	1
THE NECCESSARY TOOLS	2
ROOF CONSTRUCTION	2
EMARIT	3
THE ASSEMBLY OF EMARIT	4
THE DETAIL OF FIRST LINE APPARATUS	5
THE DETAIL OF THE ROUND RIDGE	6
THE DETAIL OF THE VALLEY GROOVE	7
THE WALL DETAIL	
THE DETAIL OF THE COVER FLASHING	8
THE DETAIL OF THE COVER FLASHING CORNER GUSSET	8
THE DETAIL OF THE HEADWALL FLASHING	8
THE DETAIL OF THE CORNER FLASHING GUSSET	9
THE DETAIL OF THE SIDEWALL FLASHING	10
THE DETAIL OF THE SNOW RAKE	11
THE DETAIL OF THE CHIMNEY	12

INTRODUCTION

The instructions and drawings included here are intended only as a guide for the installation of the Emarit and accessories. The materials and methods specified help maintain the overall integrity of the roofing system. These intruductions are not intended to adress all aspects of roofing installation. A quality installation is ultimatiy depend on the workmanship by the roofing contactor.

STORAGE

If the storage is outside the materials must be covered and protected from rain, etc
Maximum stow is 10 packets.

HEAT AND HUMIDITY INSULATION

The thermal insulation and the condensation control should be done according to the local building standarts where building is constructed.

It is the responsibility of the architects,builders and roof installers to ensure that local standarts,by-laws and requirement are satisfied.

HANDLING

Traffic on the roof should be kept to a minumum to avoid possible damage to the tiles.

The tiles should be handled with care in order.

The tiles should not bend o r twist.

IMPORTANT ISSUES WHILE ASSEMBLING

-Should be used rubber shoes while walking on the roof.

-Should be used safety belt during the assembly

-Should clean any metal burs on the roof following assembly

-During the raining or while the Emarits wet it should not walk on it

-After the cutting which is done at the necessary places , during the assembly it must be retouched with paint at cutting section.

-The Emarit and accessories must be complete screwed from assembly sections , And the Emarit 's hook system must be interlocked each other.

THE NECCESARY TOOLS

Rubber hammer

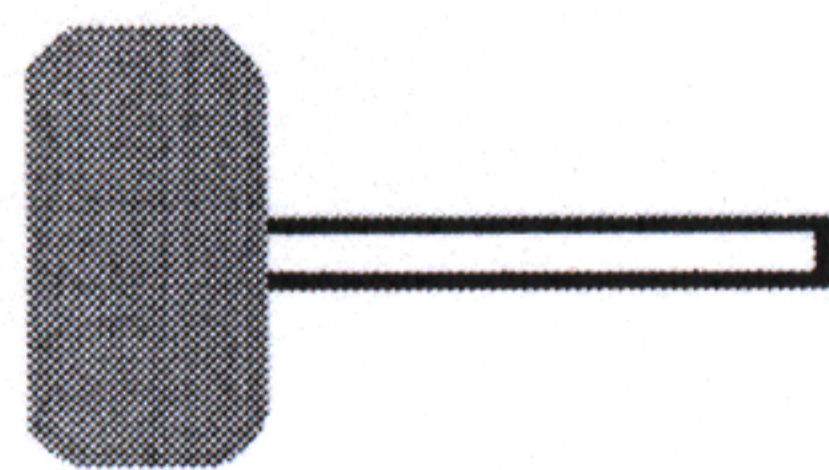

Screw rill

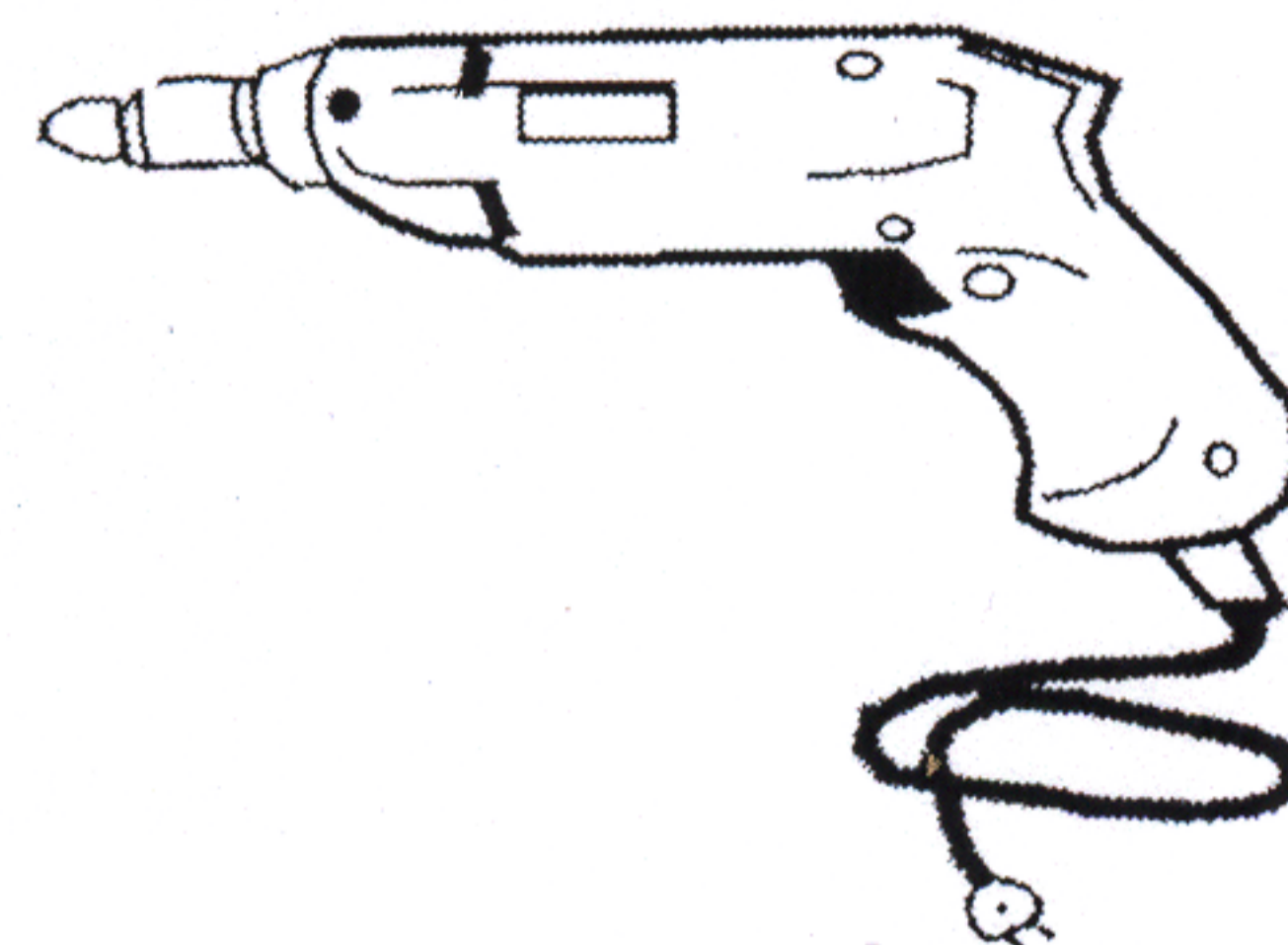

Screw



Electric Disc Grinder



ROOF CONSTRUCTIONS

Roof slope should be 20 % min

The necessary battens should be as below :

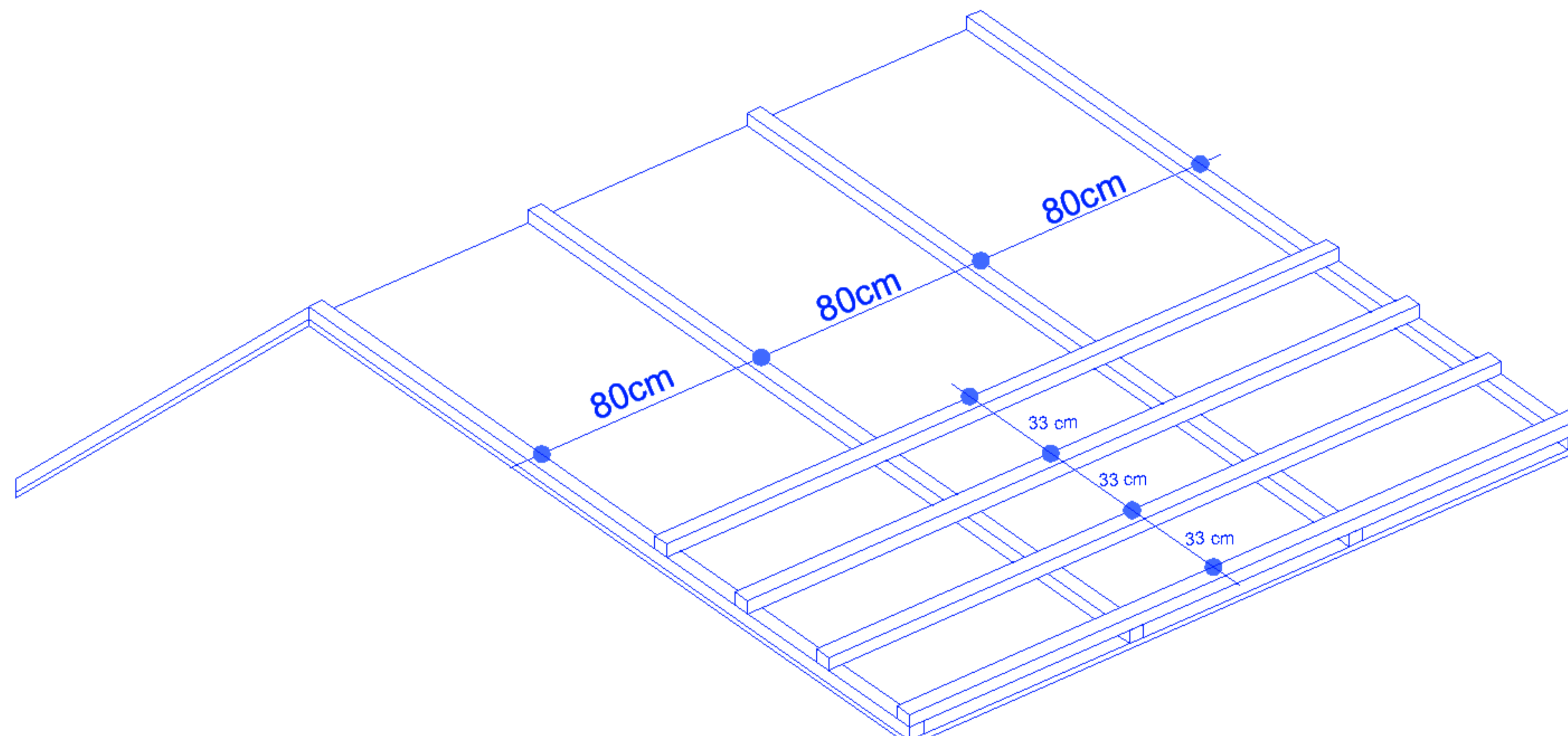

EMARIT

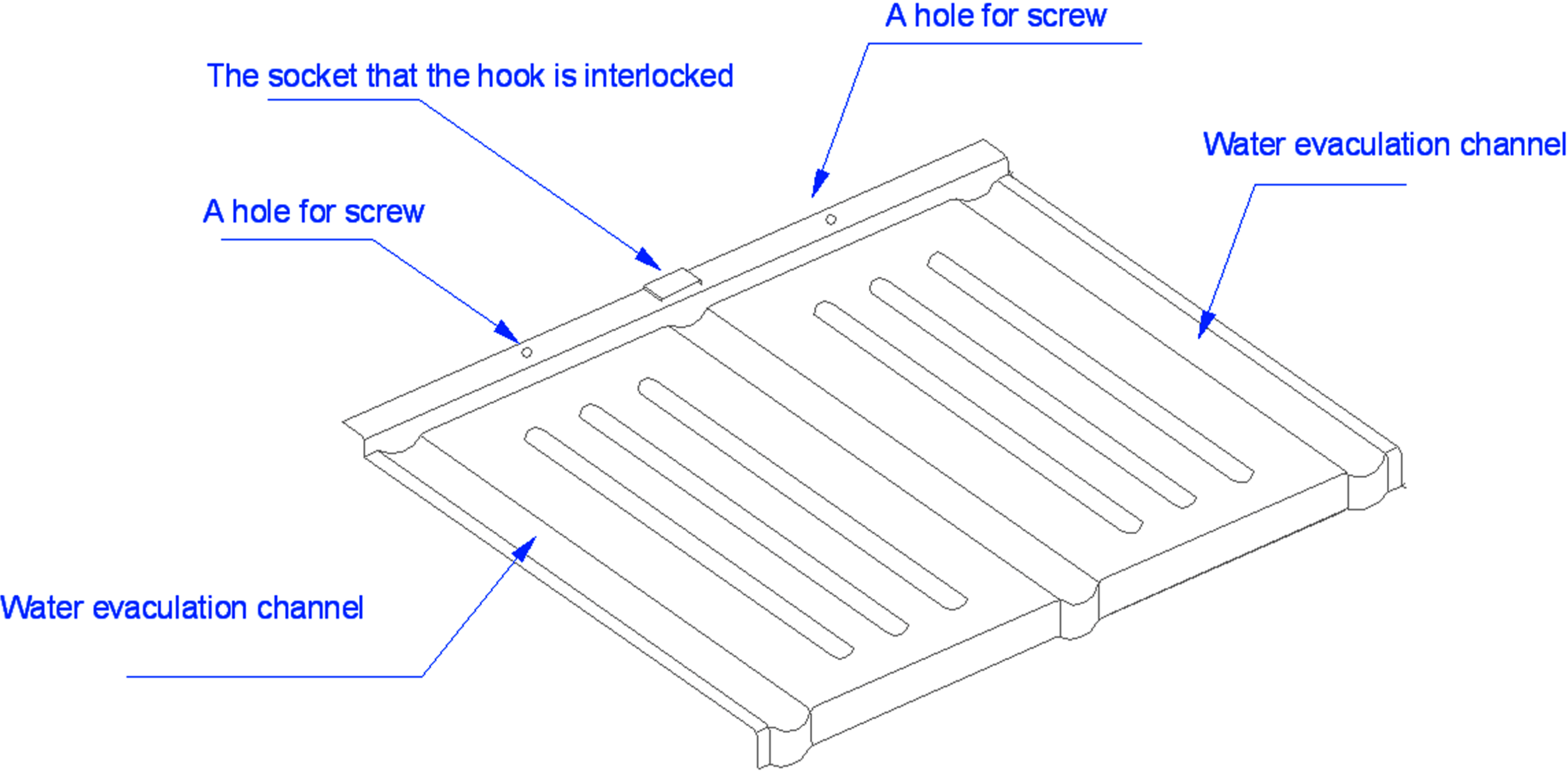

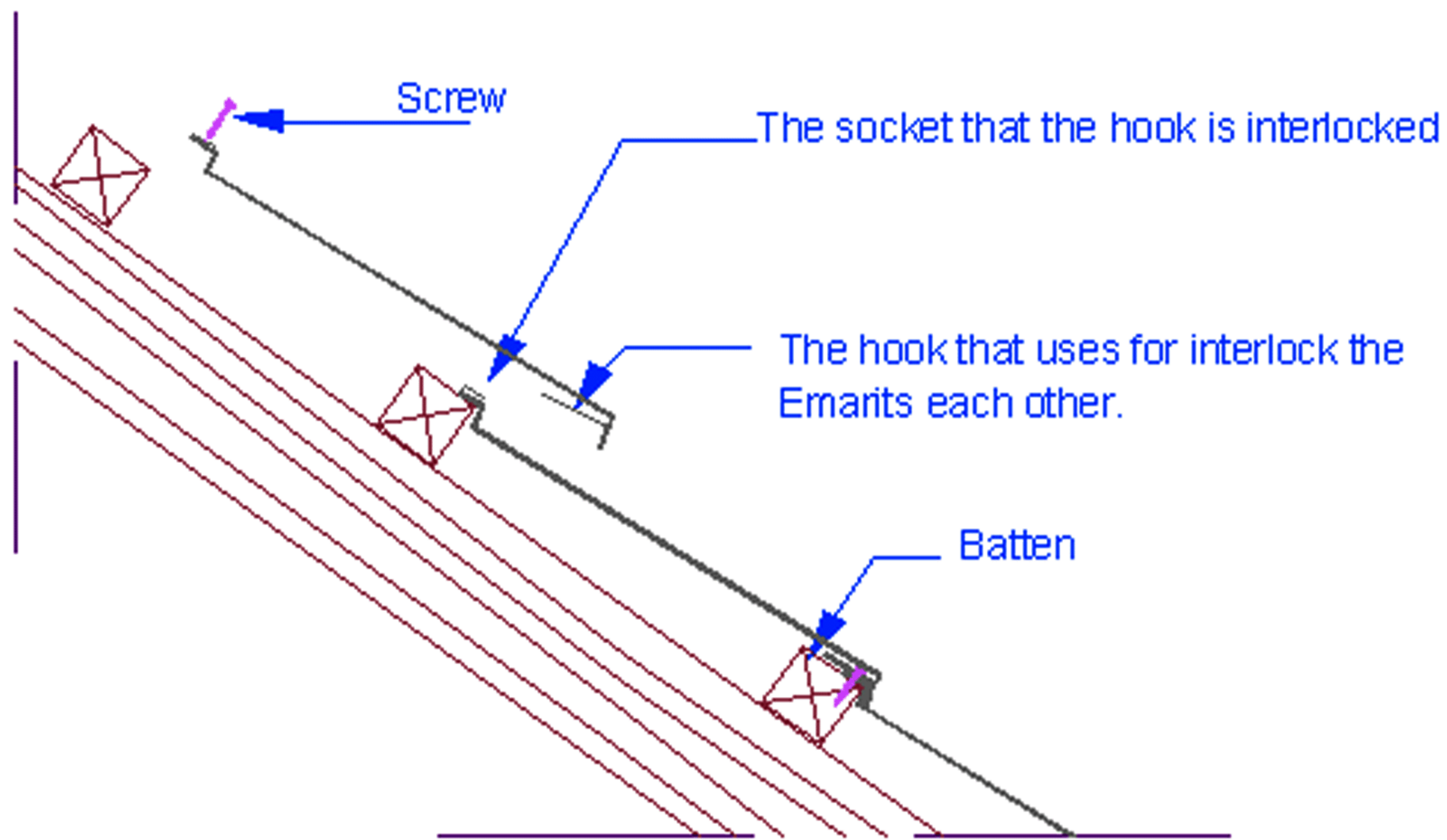

Every Emarit is screwed two times to the roof construction and interlocks each other with their hook systems. The upper side Emarit cover the lower part side of Emarits screws so any screws are not seen.

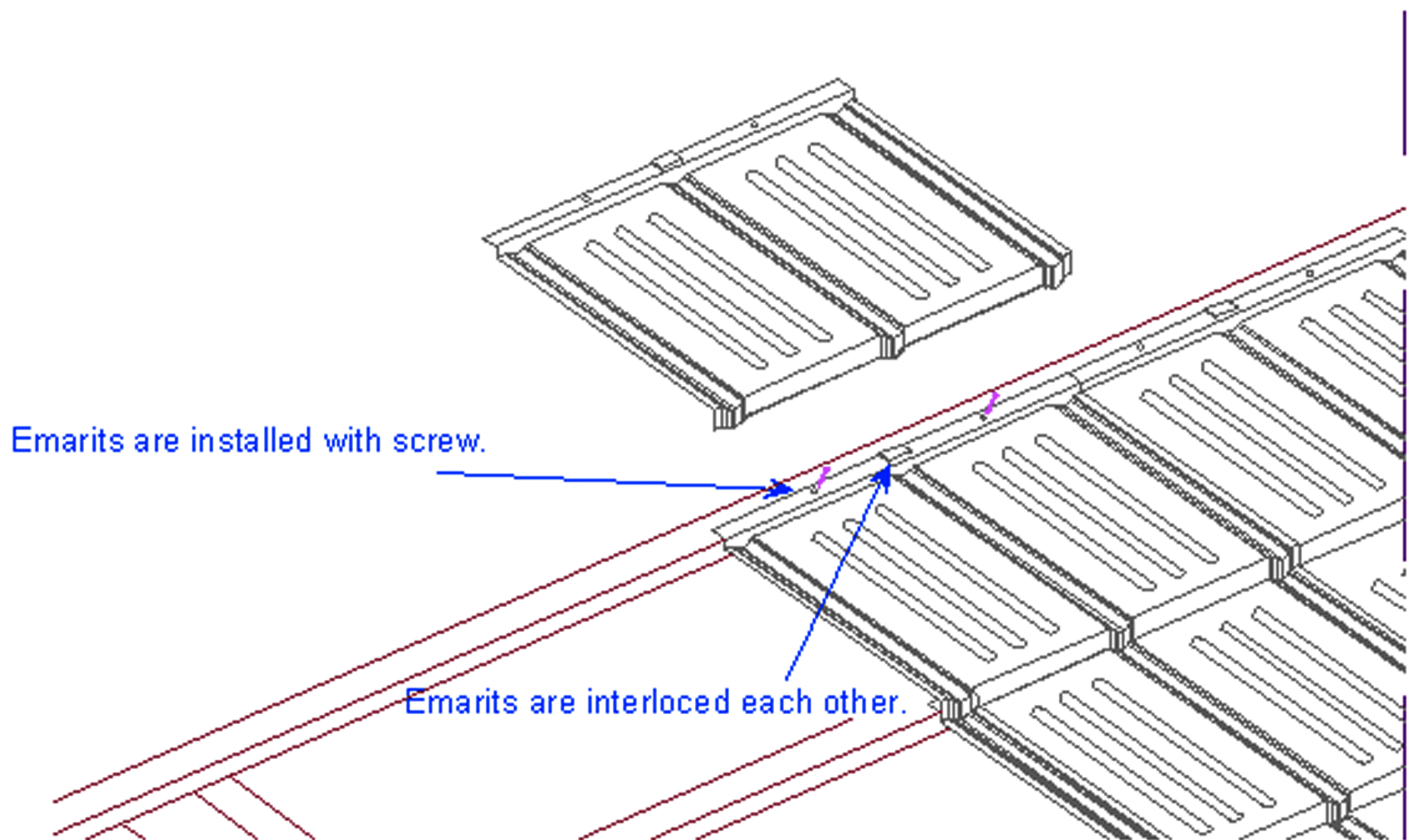

EMARIT EM 0101

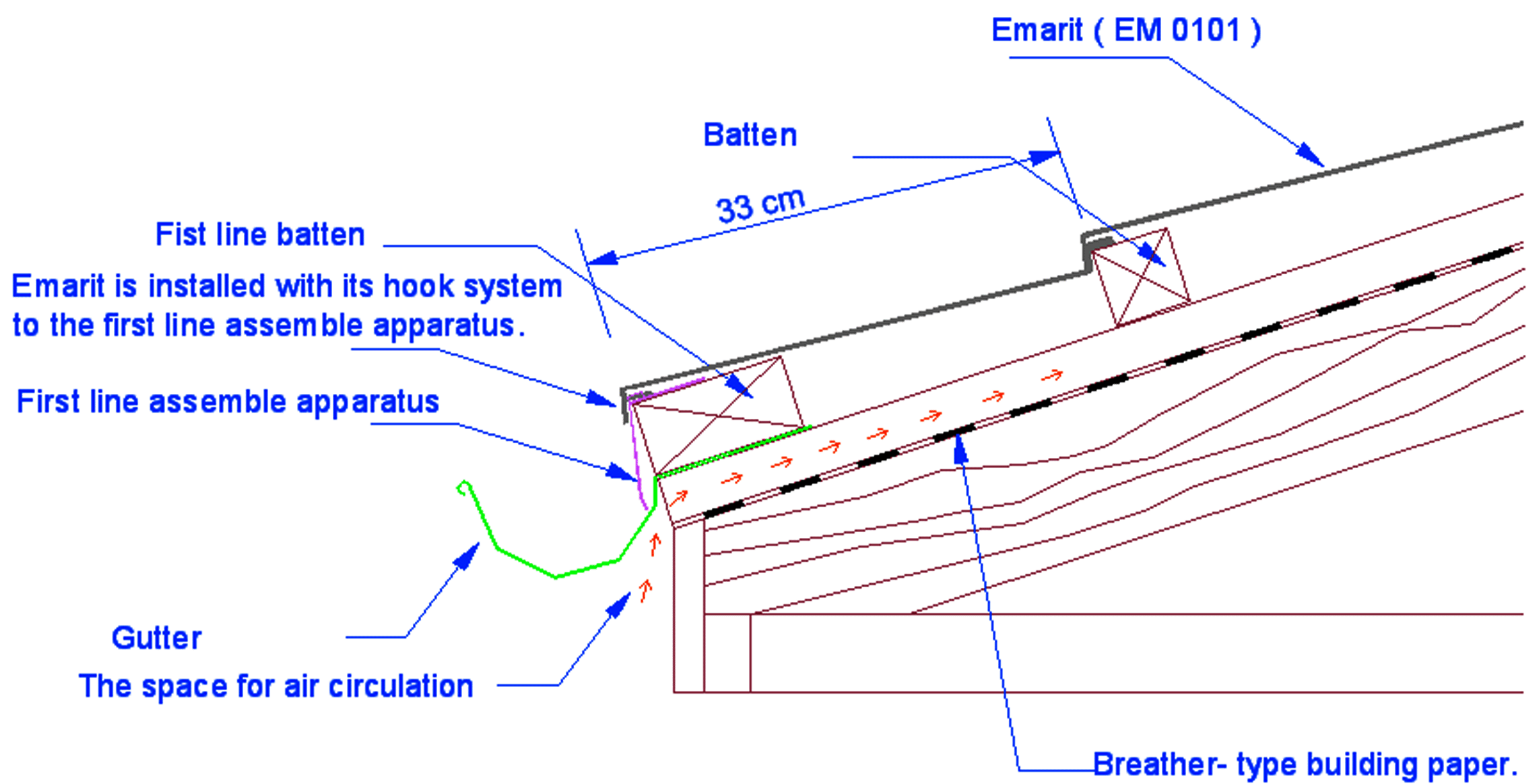

FIRST LINE ASSEMBLE APPARATS EM 301

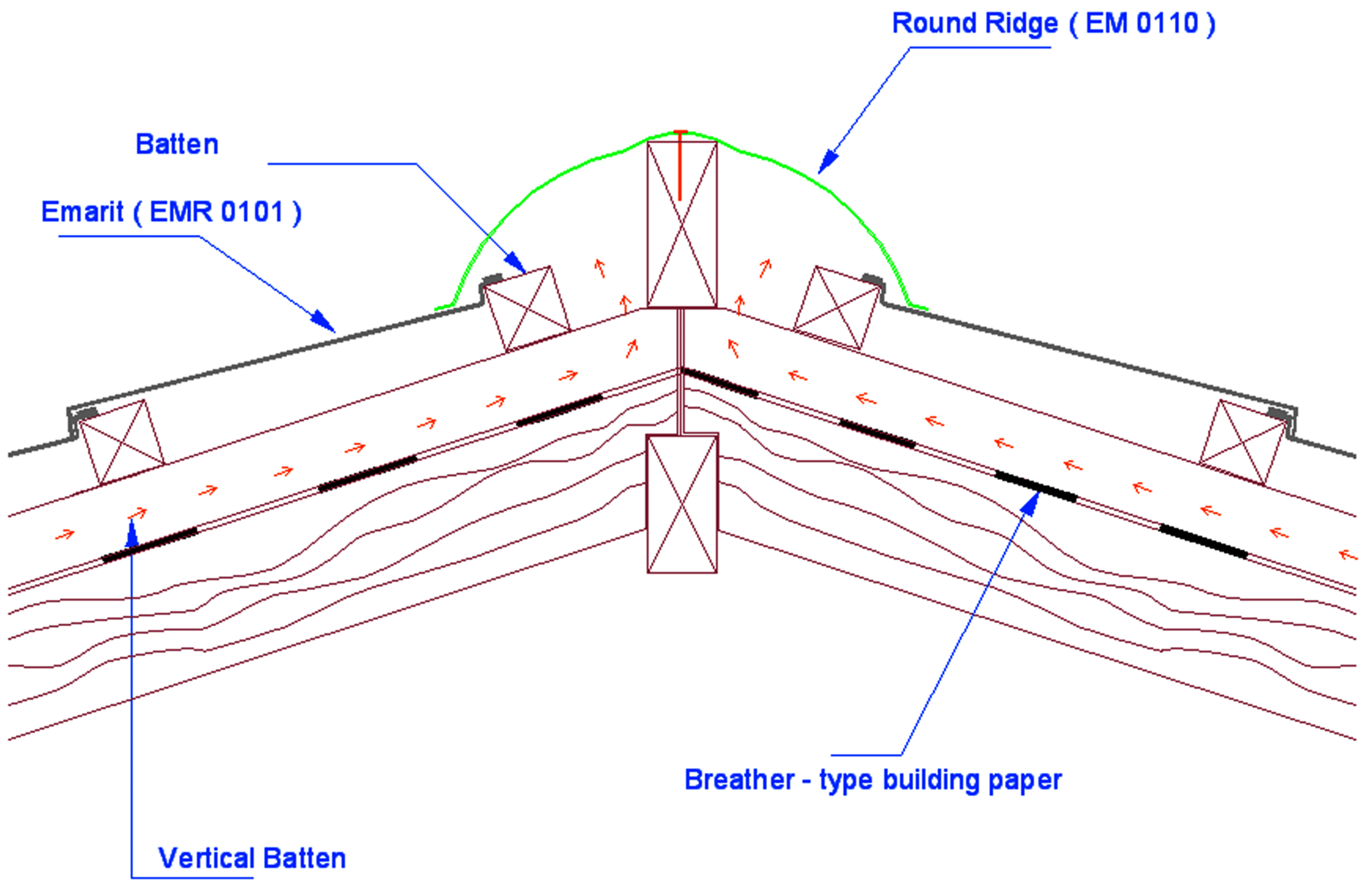

ROUND RIDGE EM 0110

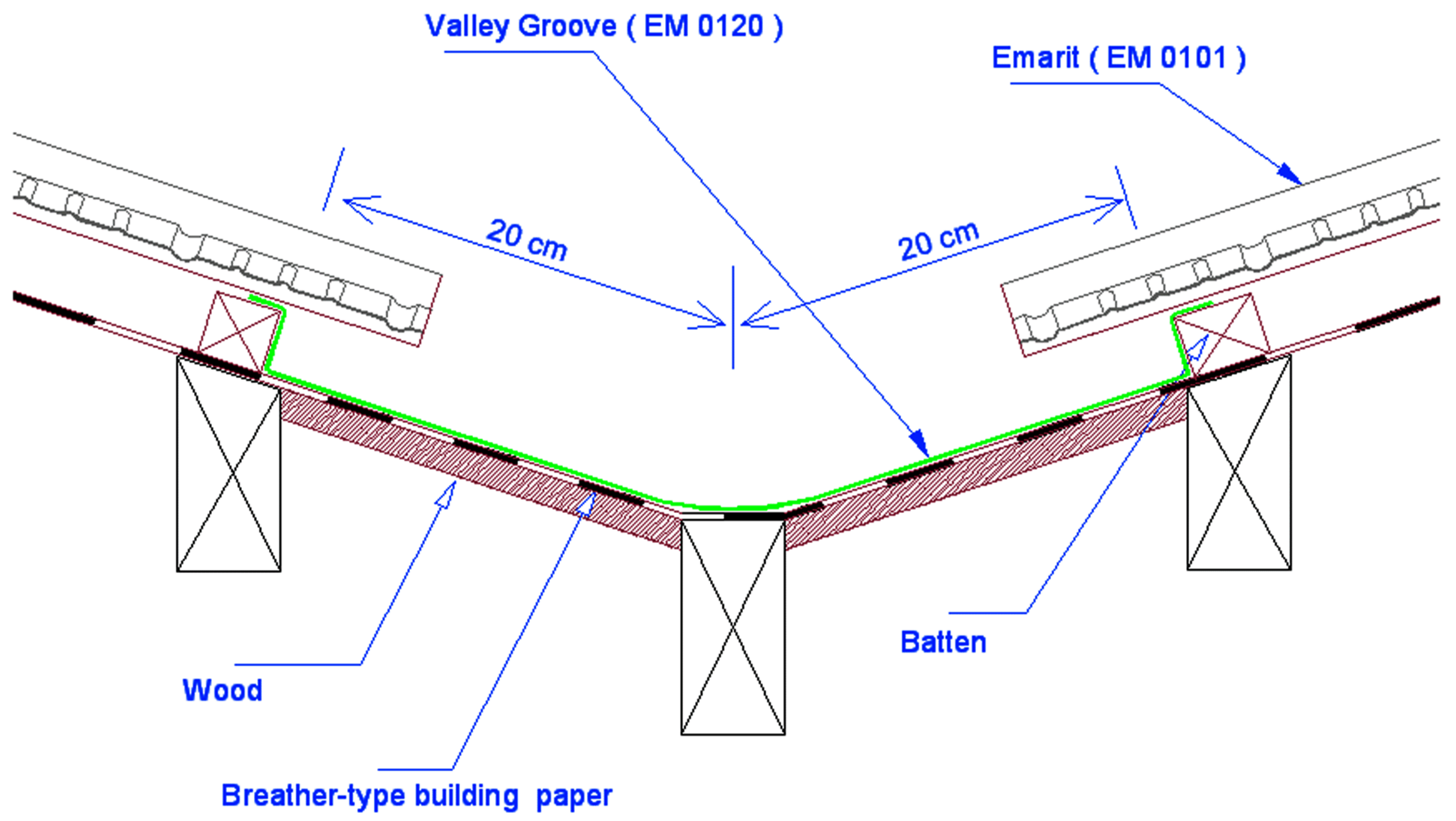

VALLEY GROOVE EM 0120

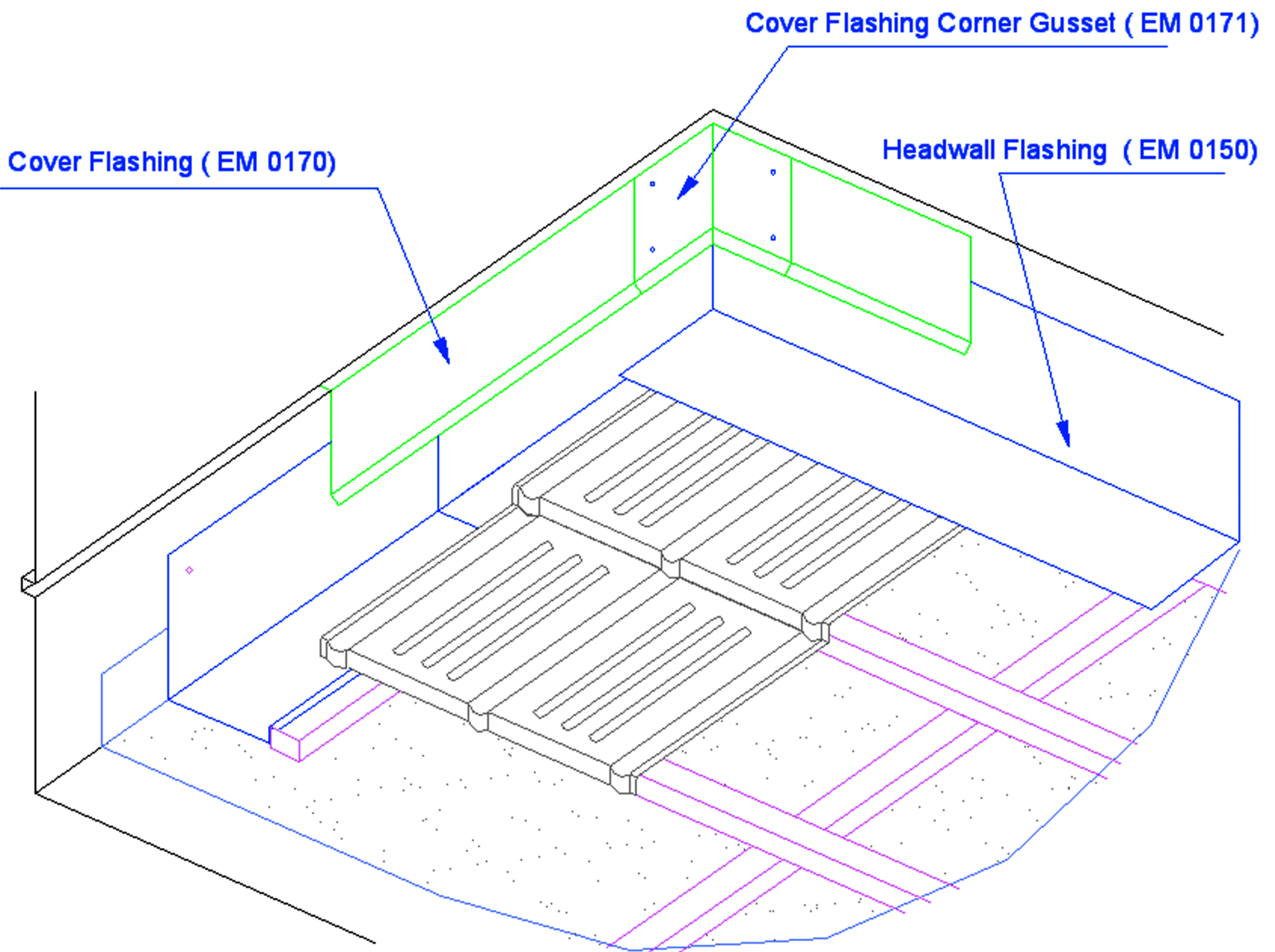

COVER FLASHING EM 0170

COVER FLASHING CORNER GUSSET EM 0171

HEADWALL FLASHING EM 0150

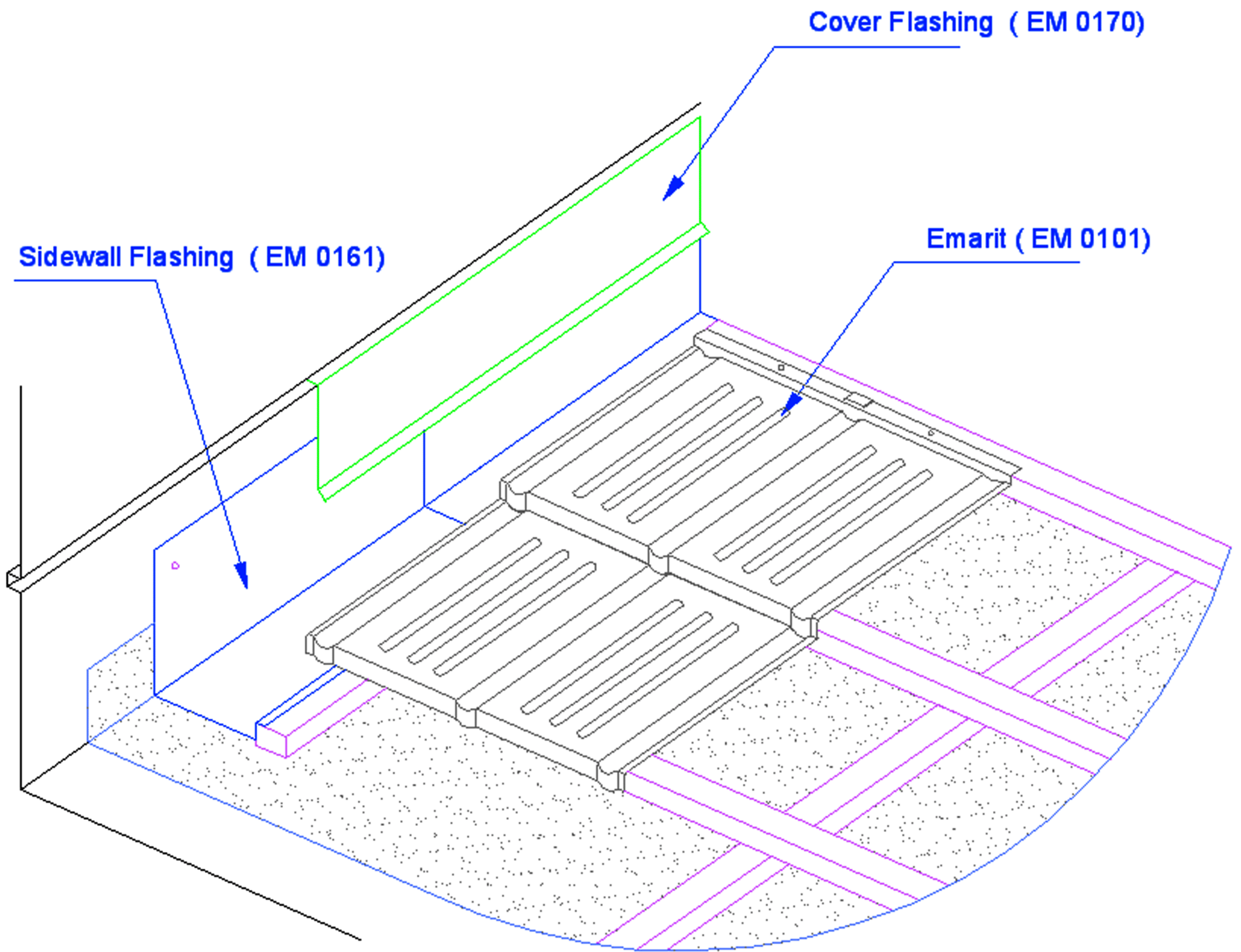

SIDEWALL FLASHING EM 0161

COVER FLASHING EM 0170

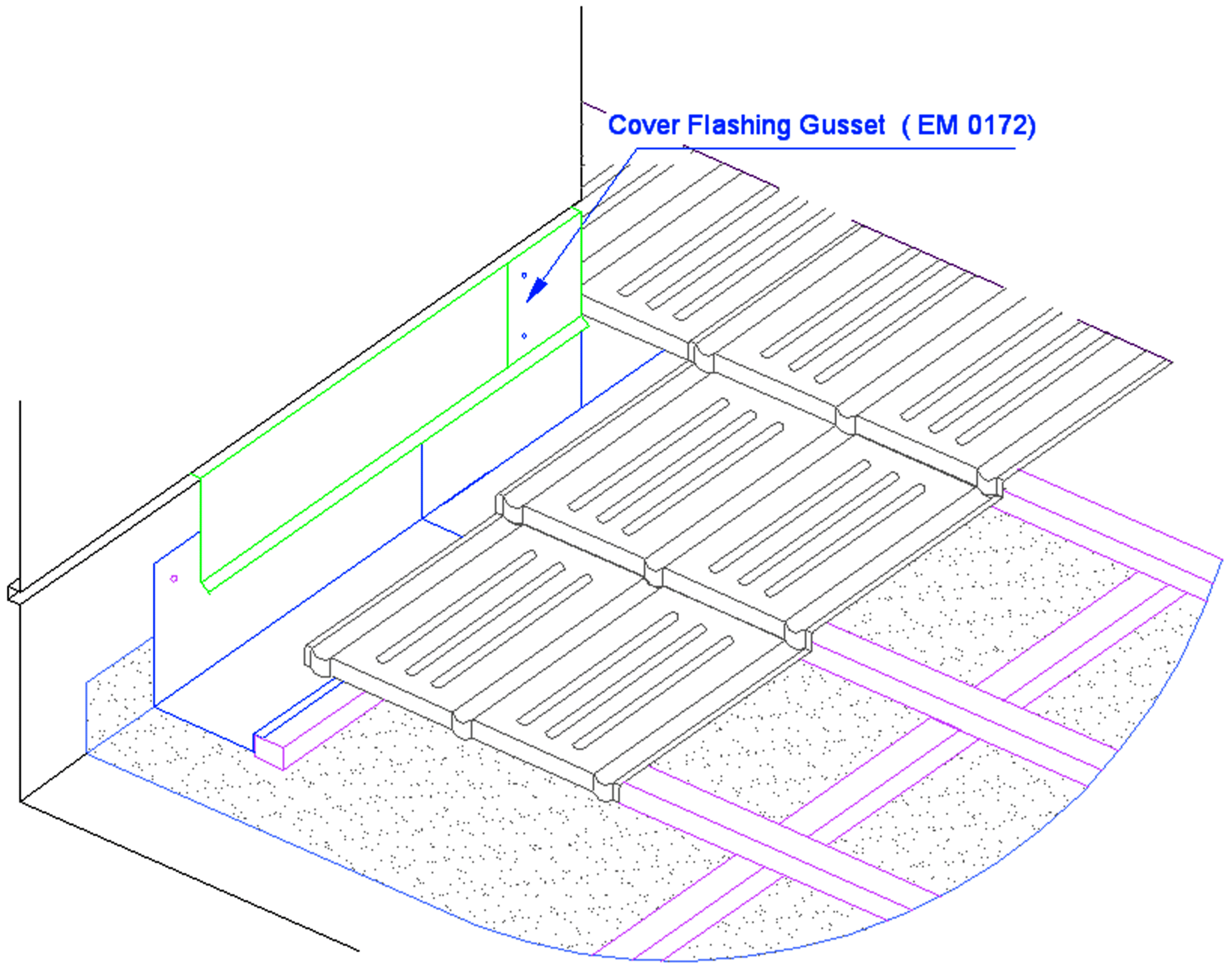

Cover Flashing Gusset (EM 0172)

COVER FLASHING EM 0172

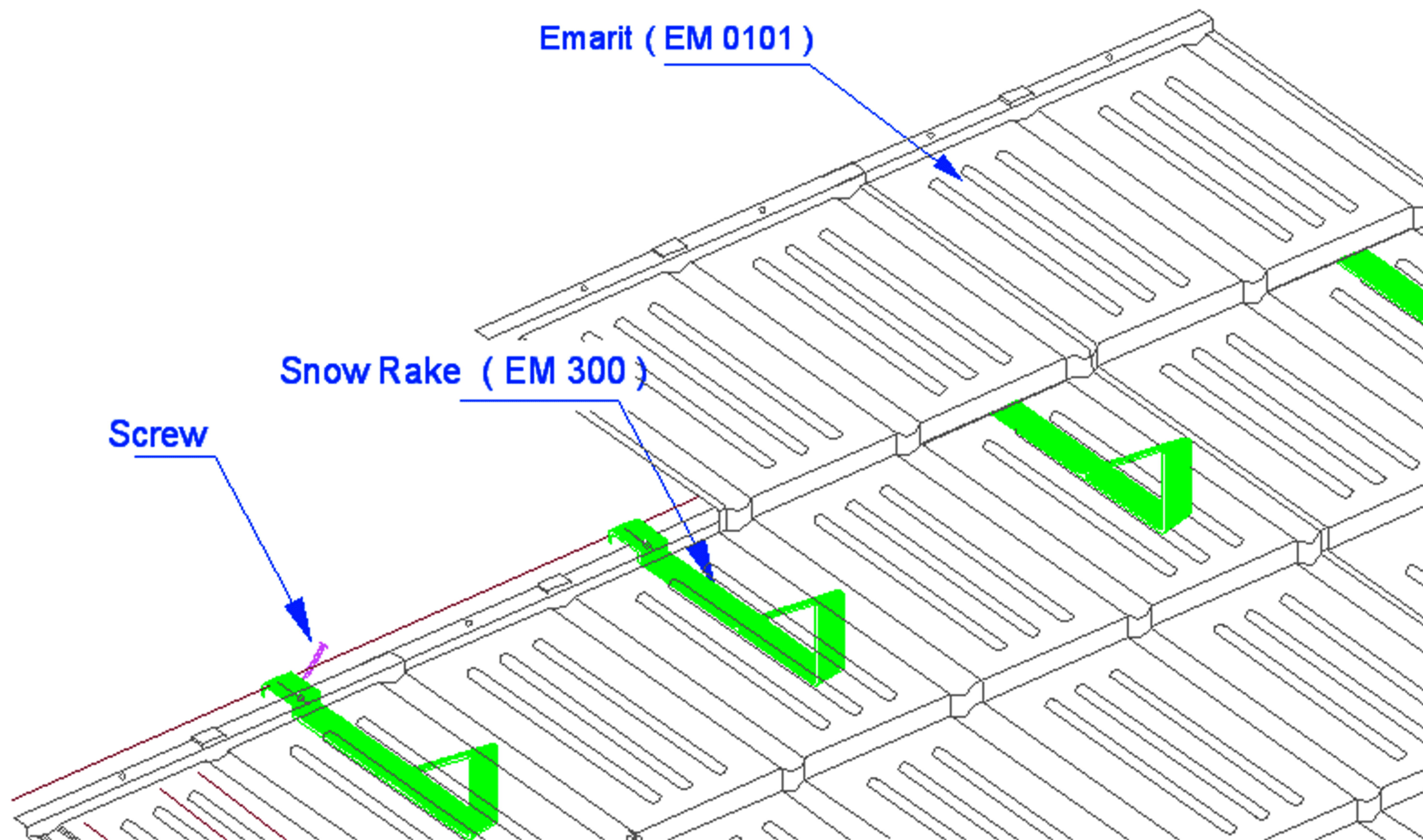

SNOW RAKE EM 300

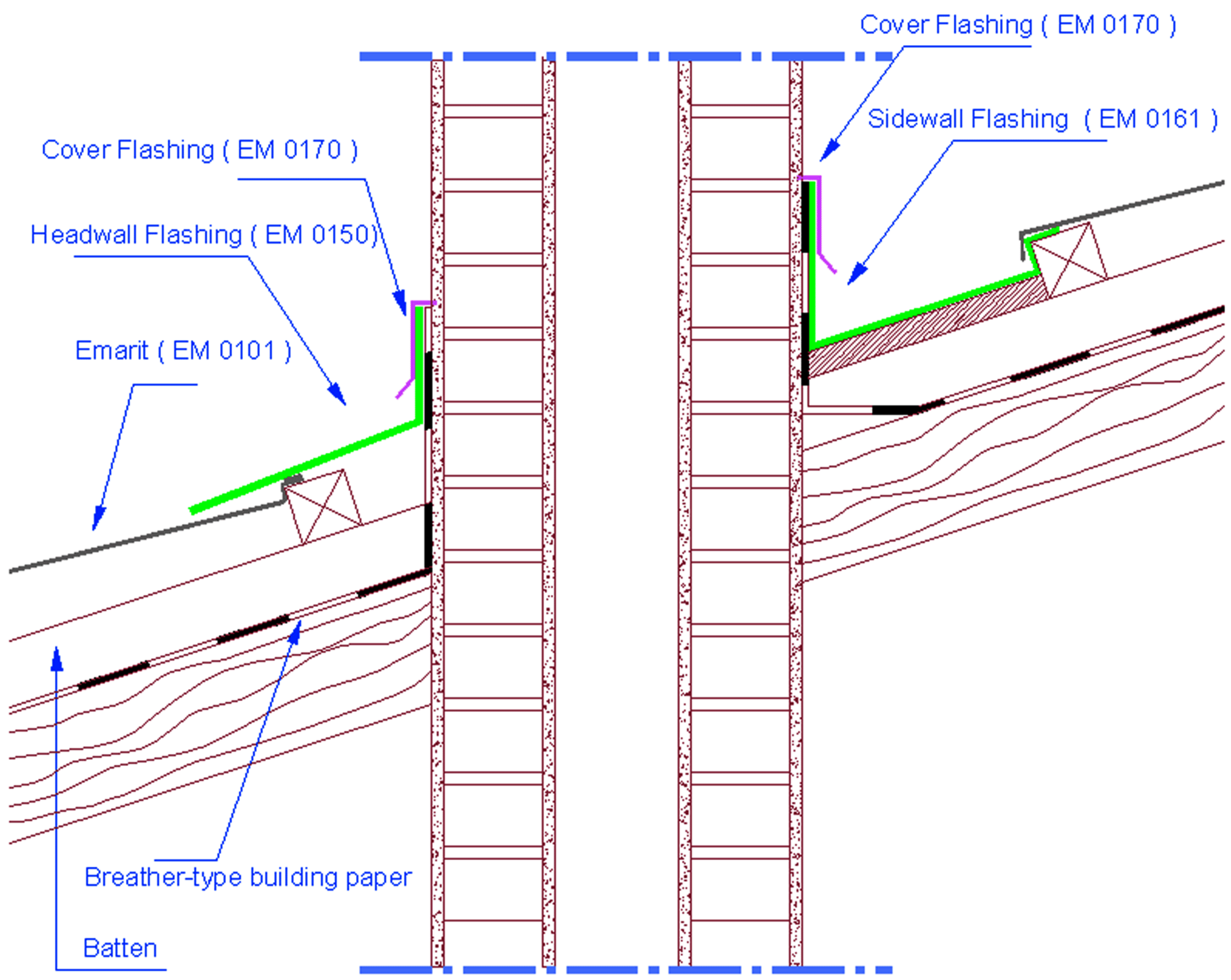

DETAIL OF CHIMNEY